

REVISION	DATE	COMMENTS
3	9-7-2017	BULLETIN 6

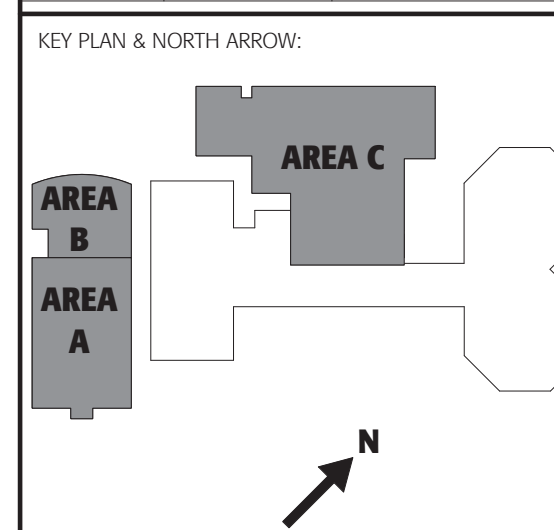

PROJECT:
GOLDEN BROOK ELEMENTARY
SCHOOL
PHASE 1
112B LOWELL RD,
WINDHAM, NH 03087

ISSUED:
PHASE II 50%

DRAWING TITLE:
LEVEL 1 - OVERALL

PROJECT NO: 15-332 DATE: 8/25/2017

SHEET NUMBER:

A101

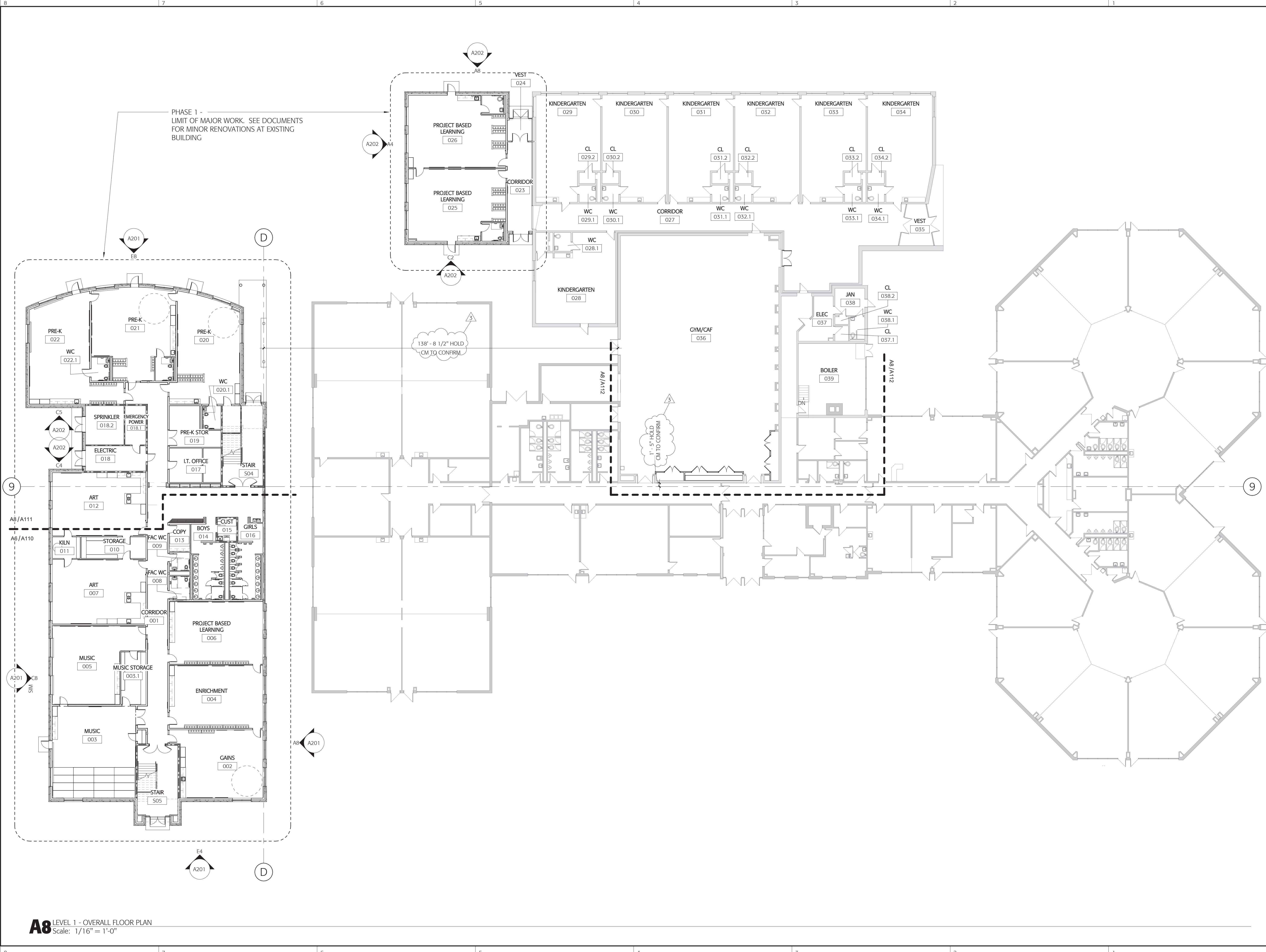

PHASE 1 -
LIMIT OF MAJOR WORK. SEE DOCUMENTS
FOR MINOR RENOVATIONS AT EXISTING
BUILDING

138' - 8 1/2" HOLD
CM TO CONFIRM

11' - 5" HOLD
CM TO CONFIRM

A8 LEVEL 1 - OVERALL FLOOR PLAN
Scale: 1/16" = 1'-0"

CONSULTANTS / DESIGN TEAM:

OWNER:
SAU #59
19 HAVERHILL ROAD
WINDHAM, NH 03087
T: (603) 425-1976

CONSTRUCTION MANAGER:
THE MACMILLIN COMPANY - A DEW
CONSTRUCTION AFFILIATE
17 ELM STREET
KEENE, NH 03431
T: (603) 352-3070

ARCHITECT:

BANWELL ARCHITECTS
6 SOUTH PARK STREET
LEBANON, NH 03766
T: (603) 448-3778

CIVIL ENGINEER:

TIGHE & BOND
177 CORPORATE DRIVE
PORTSMOUTH, NH 03801
T: (603) 433-8818

STRUCTURAL:

FOLEY BUHL ROBERTS & ASSOC.
500 COMMERCIAL STREET
MANCHESTER, NH 03101
T: (603) 622-4578

MPFE ENGINEER:

FITZMEYER & TOCCI ASSOCIATES
300 UNICORN PARK DR, 5TH FL
WOBBURN, MA 01801
T: (781) 285-2290

ACOUSTIC ENGINEER:

CAVANAGH TOCCI
327 BOSTON POST ROAD
SUDBURY, MA 01776
T: (978) 443-7870

CODE CONSULTANT:

SHARON MIGNARDI
10151 UNIVERSITY BLVD #195
ORLANDO, FL 32817
T: (407) 677-1102

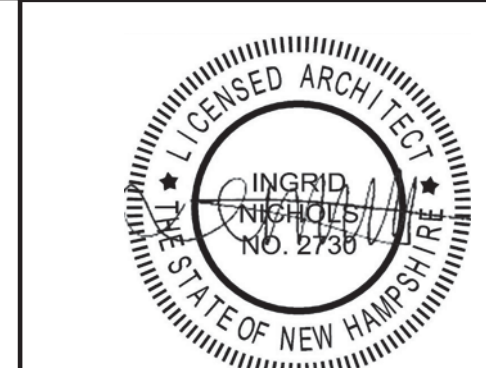

REVISION	DATE	COMMENTS

KEY PLAN & NORTH ARROW:

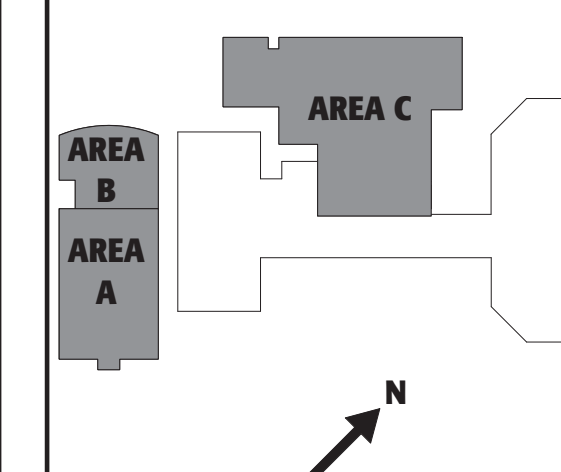

PROJECT:
GOLDEN BROOK ELEMENTARY
SCHOOL
PHASE 1
112B LOWELL RD,
WINDHAM, NH 03087

ISSUED:
PHASE 1 - ISSUED FOR
CONSTRUCTION

DRAWING TITLE:
LEVEL 2 - OVERALL

PROJECT NO: 15-332 DATE: 7/21/2017

SHEET NUMBER:

A102

